

BED HINGE DELTA 300

- Minimal mounting height 33mm
- Maximal opening 300mm
- Number of teeth: 11
- Surface finish galvanised yellow
- Quick mounting
- Lateral stable design
- LGA tested (QZ no. 957)

Schätti AG, Metallwarenfabrik
Industrie Tschachen 2
CH-8762 Schwanden

Telefon +41 (0)55 647 34 11
Fax +41 (0)55 647 34 21

www.schaetti-ag.ch
info@schaetti-ag.ch



Mounting elements for bolting on

- Mounting holes \varnothing 4,5 mm
- All mounting elements are supplied in galvanised steel

upper fastening

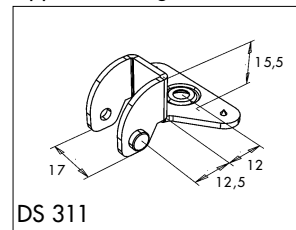

lower fastening

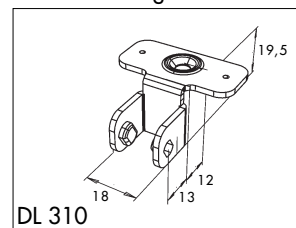

Contact us for advice on hinge selection and mounting.
Subject to alternations.